



High Road, Whetstone, N20

 3 Bedrooms  1 Bathroom  1 Reception

Guide Price £550,000



Adam Hayes - North Finchley Office - Sales 365 Ballards Lane, North Finchley, London, N12 8LL  
Tel: 020 8445 4008 Email: [info@adam-hayes.co.uk](mailto:info@adam-hayes.co.uk) Web: [www.adam-hayes.co.uk](http://www.adam-hayes.co.uk)

# High Road, Whetstone, N20

## Guide Price £550,000

 3 Bedrooms  1 Bathrooms  1 Receptions

### Key Features

- Three Bedrooms
- Ground Floor Apartment
- Modern Four Piece Bathroom
- Open Plan Kitchen
- Stunning Rear Garden
- Off Street Parking

### Other Information

Tenure: Share of Freehold  
Length of Lease: 961 Years  
Ground Rent: Nil  
Service Charge: Nil  
Building Insurance: £225.00 P/A  
Council Tax Band: C



### Nearest Stations

Woodside Park Station 0.5 miles  
Totteridge & Whetstone Station 0.5 miles  
West Finchley Station 1.1 miles

### Property Description

Set back from Whetstone High Road and conveniently located within minutes' walk of local shops and amenities is this stunning three-bedroom ground-floor apartment. The property is offered chain free and benefits from an array of contemporary features including a modern kitchen with centre island, sliding patio doors leading to a landscaped private rear garden and a spacious reception room filled with ample natural light. Other benefits include a modern four-piece bathroom suite, a share of the freehold and off-street parking. This residence presents an appealing opportunity for first-time buyers or those looking to downsize. To fully appreciate the size, location, and potential of this property, an internal viewing is highly recommended through the vendor's sole agents, Adam Hayes Estate Agents.

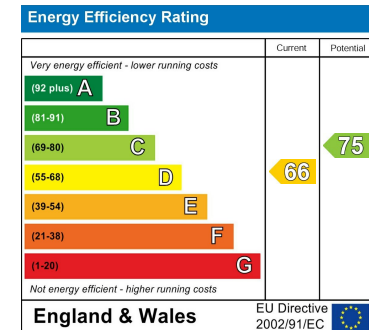

Adam Hayes - North Finchley Office - Sales 365 Ballards Lane, North Finchley, London, N12 8LL

Tel: 020 8445 4008 Email: info@adam-hayes.co.uk Web: www.adam-hayes.co.uk

Approximate Gross Internal Area  
697 sq ft - 65 sq m

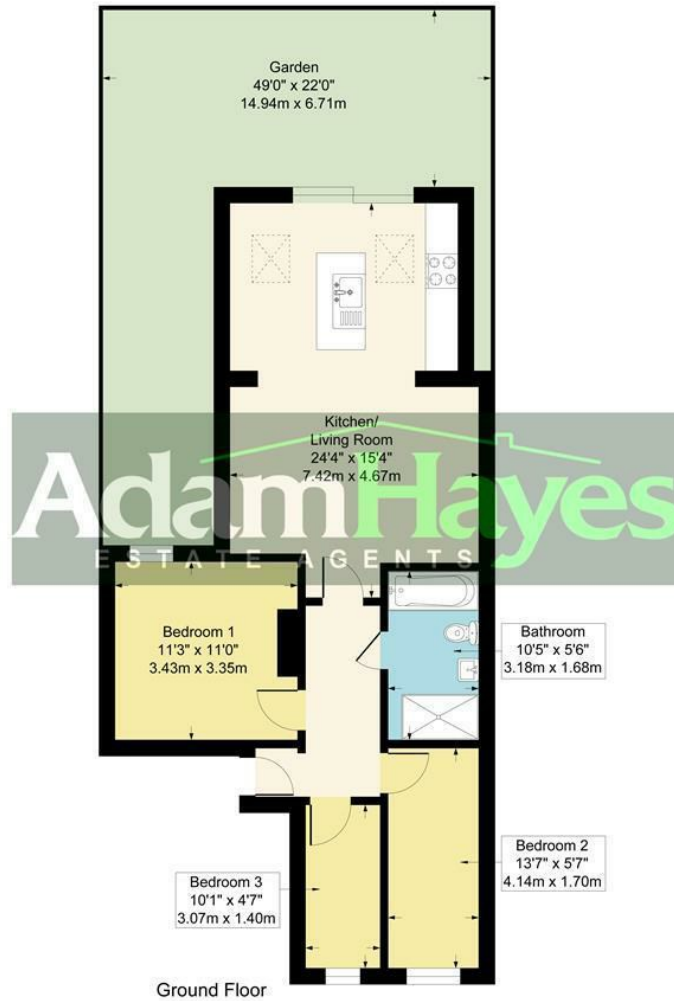

Although every attempt has been made to ensure accuracy, all measurements are approximate.  
This floorplan is for illustrative purposes only and not to scale.  
Measured in accordance with RICS Standards.

These particulars, whilst believed to be accurate, are set out as a general outline only for guidance and do not constitute any part of an offer or contract. Intending purchasers or prospective tenants should not rely on them as statements or representation of fact, but must satisfy themselves by inspection or otherwise as to their accuracy. We have not carried out a detailed survey, not tested the services, appliances and specific fittings. Room sizes should not be relied upon for carpets and furnishings. The measurements given are approximate. No person in this firm's employment has the authority to make or give any representation or warranty in respect of the property.